

*marimba one*®

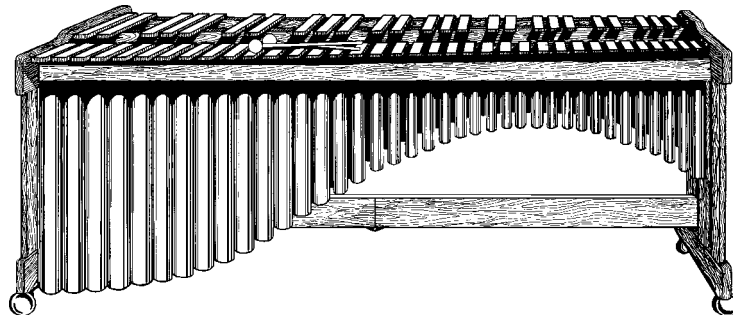

OWNER'S MANUAL

# marimba one<sup>®</sup>

— WOOD FRAME —  
ASSEMBLY INSTRUCTIONS  
& OWNER'S MANUAL

- FOR ASSEMBLY YOU WILL NEED:
- A large open space with carpet (or a blanket to cover the floor)
  - An assistant to help assemble the heavy items

## STEP 1

Carefully unpack your crate and compare the components to this page.

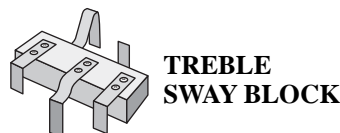
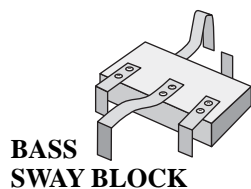
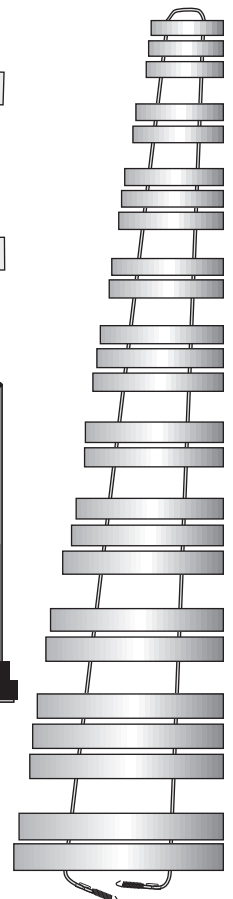
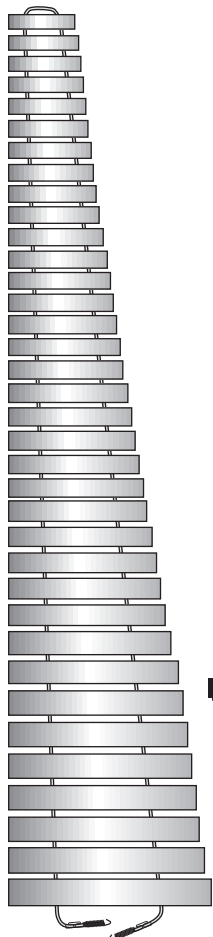
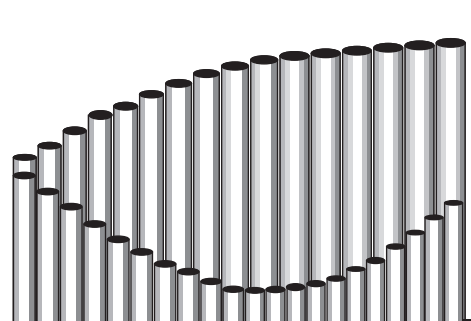
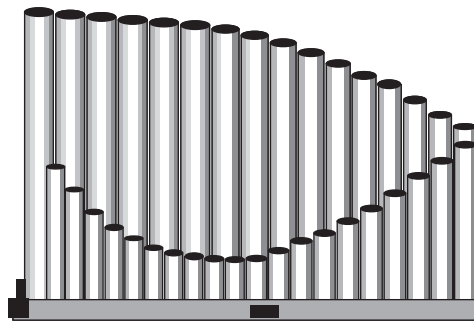
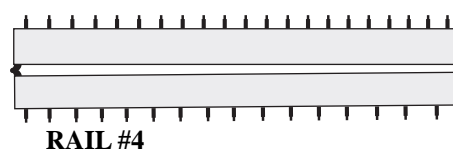
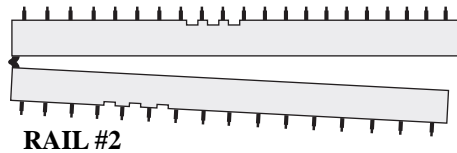
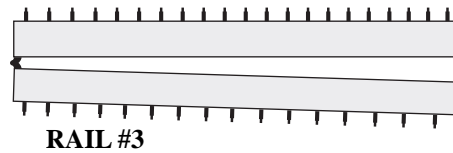
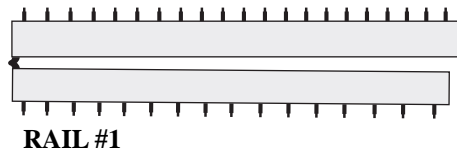
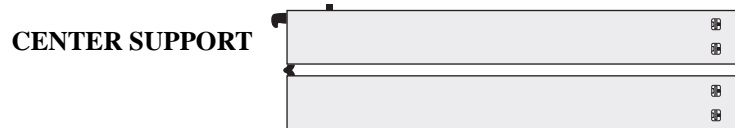
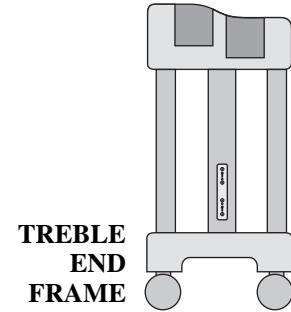
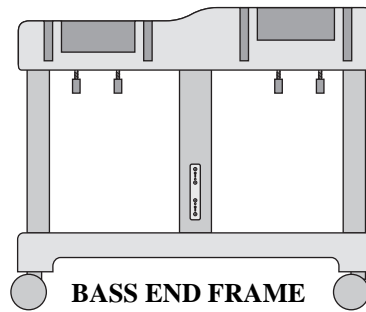

## 2

### FRAME ASSEMBLY

In a large open space with carpeting (or a blanket), arrange the frame components.

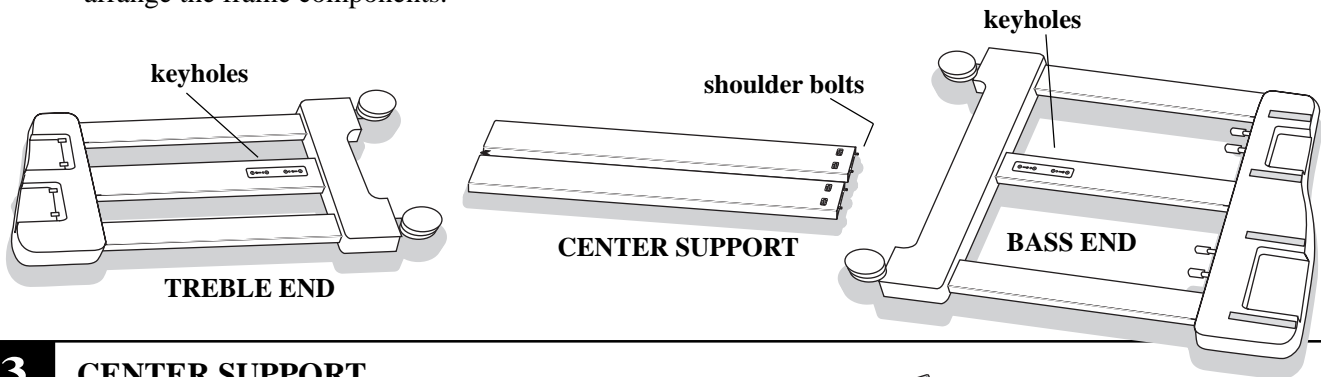

## 3

### CENTER SUPPORT

Unfold the center support completely until you hear an audible click. (Use a quick motion as the rails begin to straighten out.)

*The latch is spring-loaded and will require a certain amount of force to engage.*

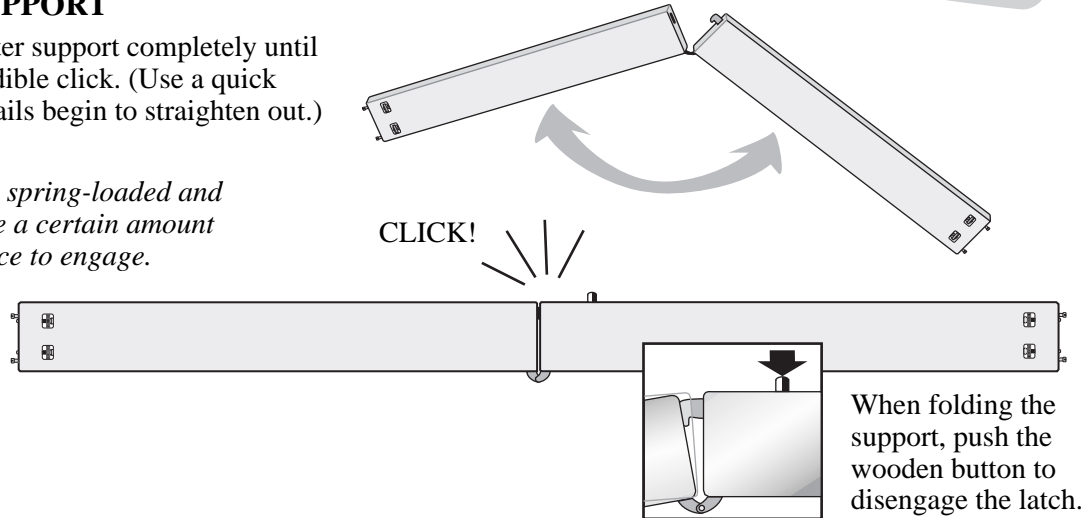

## 4

### BASS END: BUILD THE FRAME

- Have your assistant hold the bass end upright while you orient the center support with the wooden button on the top edge.
- Insert the shoulder bolts that protrude from the center support into the keyholes of the black metal plate on the frame.

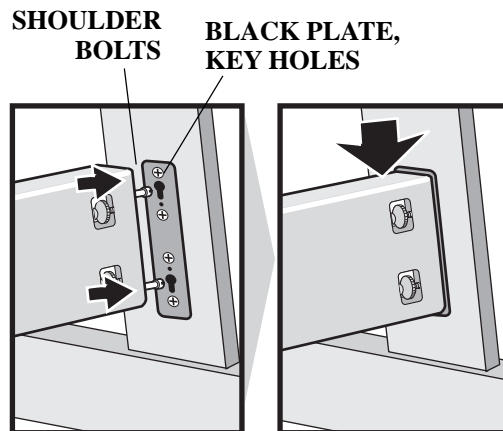

- **PRESS THE SUPPORT DOWN UNTIL THE BOLTS LOCK INTO THE KEYHOLES.**

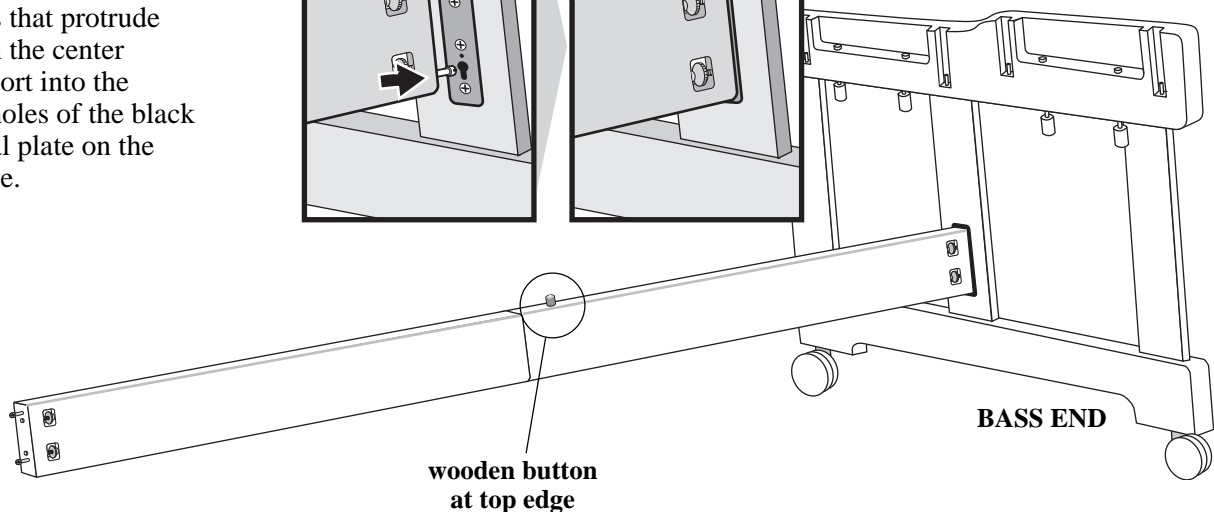

**6****TREBLE END:****REPEAT THE PROCESS FOR THE TREBLE END OF THE FRAME.**

- Have your assistant hold the treble end while you orient the center support.
- Insert the shoulder bolts that protrude from the center support into the keyholes of the black metal plate on the frame.

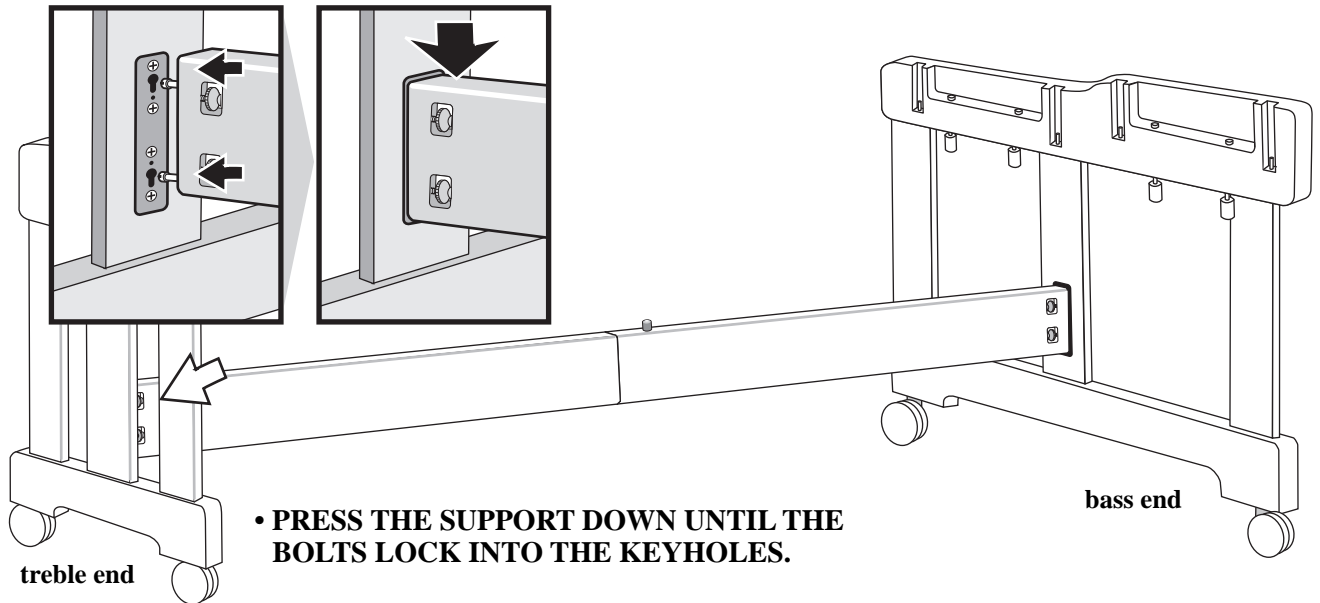
**8****TIGHTEN THE FRAME:****Adjust the Knobs.**

- Push knobs toward the frame turning clockwise until the screws engage.
- The knobs will move closer to the frames as they tighten.
- Turn all four knobs until they can no longer turn.

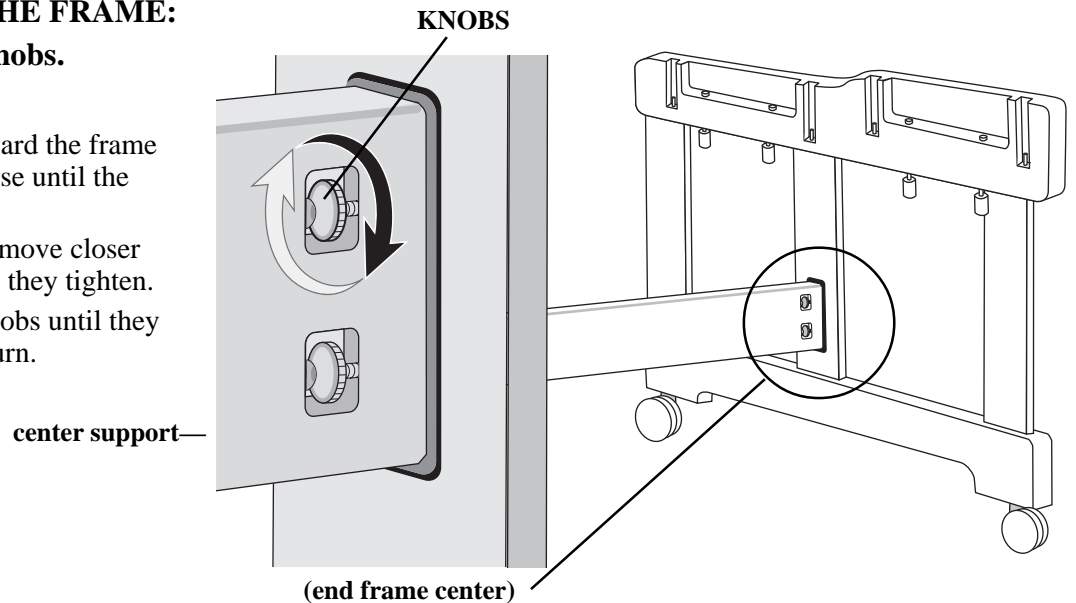
**WARNING**

**DO NOT ATTEMPT TO MOVE THE FRAMES AND CENTER SUPPORT UNTIL ALL FOUR RAILS ARE IN PLACE; THE CENTER SUPPORT MAY CRACK!**

*Cracks in the center support resulting in side to side movement before the rails are installed will not be covered by your frame warranty!*

## rail detail

*The rails are numbered in two places.*

- Player side of the bass end.
- When folded, in the cross grain of the wood on the treble side.

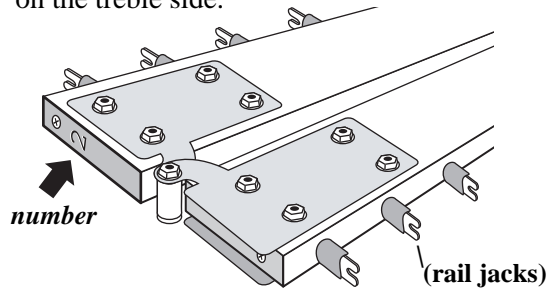

## 10

### LOCATE RAIL #2

With your assistant, unfold the rail while supporting each end.

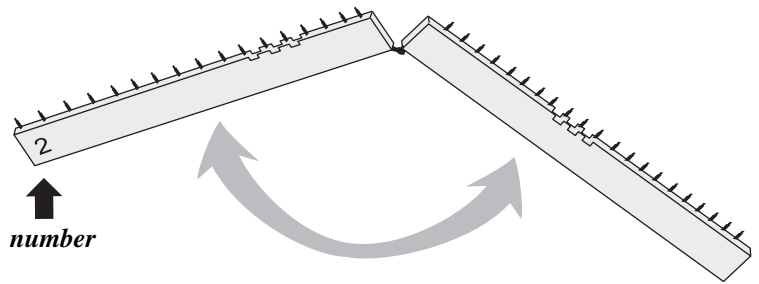

## 11

### INSTALL RAIL #2.

*Position yourself with the bass end on your left and treble end on your right.*

LOWER RAIL #2 ONTO THE CORRESPONDING METAL PINS ON THE FRAME.

*Note that the bass ends of the rails have larger gaps between the rail jacks than the treble end.*

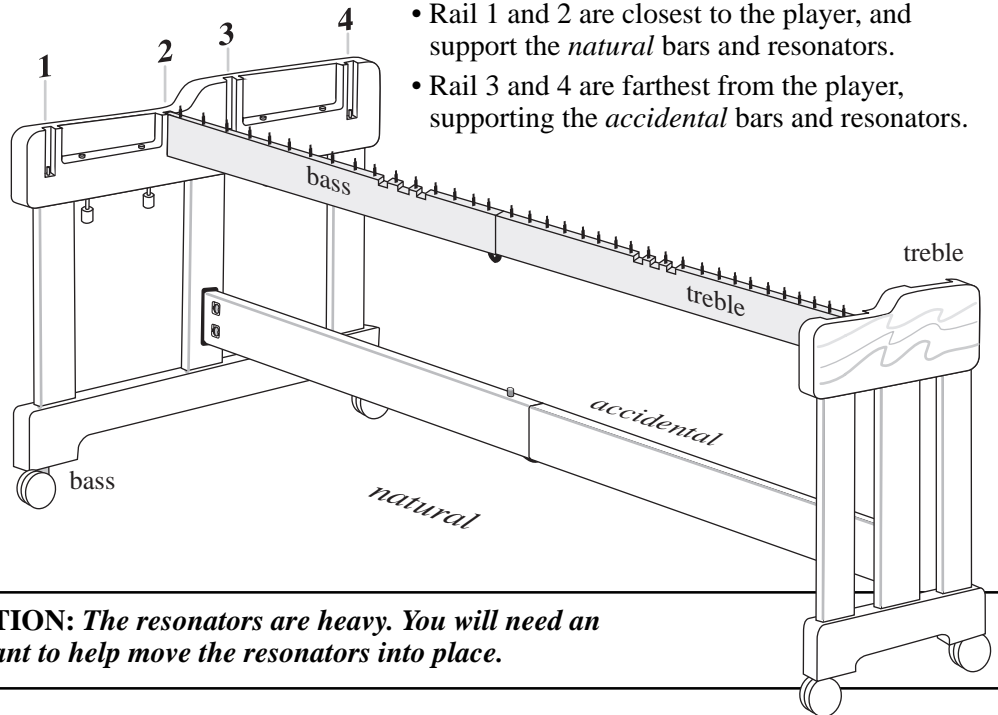

## resonators

**CAUTION:** *The resonators are heavy. You will need an assistant to help move the resonators into place.*

## 12

### IDENTIFY THE NATURAL RESONATOR BANK:

*Inside the natural resonator bank, you will see a plug in every tube. The accidental resonators are missing a plug in every 3rd or 4th tube.*

**OPEN THE RESONATORS IN THEIR NORMAL VERTICAL POSITION.**

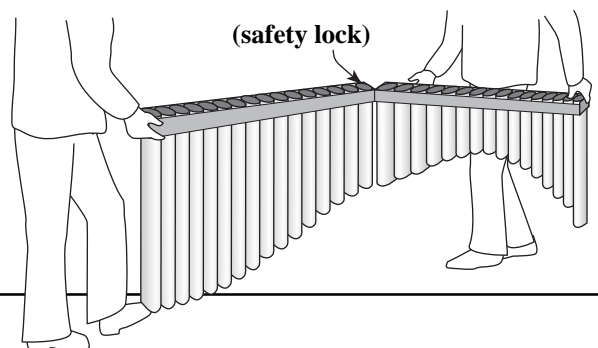

## 13

### CLOSE THE SAFETY LOCK

(located at the hinge point on the resonator bank).

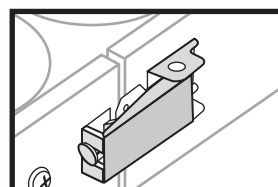
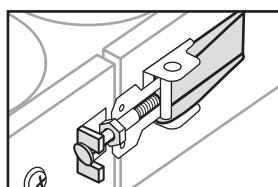
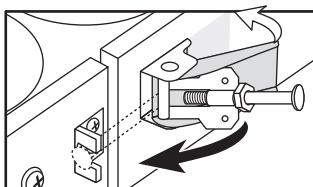

**14**

**INSTALL THE BANK OF NATURAL RESONATORS.**

With your assistant, carefully lower the bank of resonators into the frame, in front of the girders.

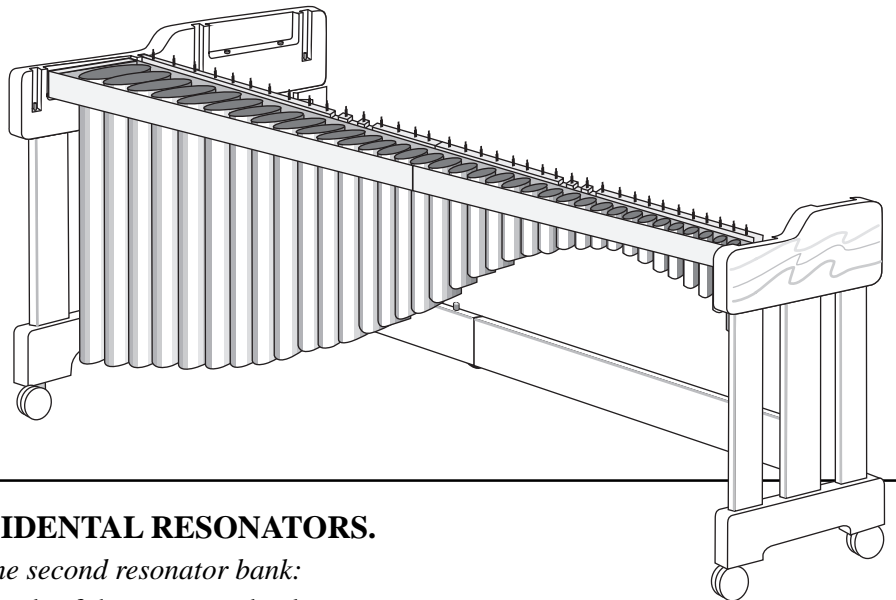

**15**

**INSTALL THE ACCIDENTAL RESONATORS.**

- Repeat the process for the second resonator bank:*
- Each person holds the ends of the resonator bank.
  - Carefully lower it into the frame.

**16**

**INSTALL RAIL #1 AND #4.**

Lower the rails onto the corresponding metal pins on the frame.

*Note that the bass ends of the rails have larger gaps between the jacks than the treble end.*

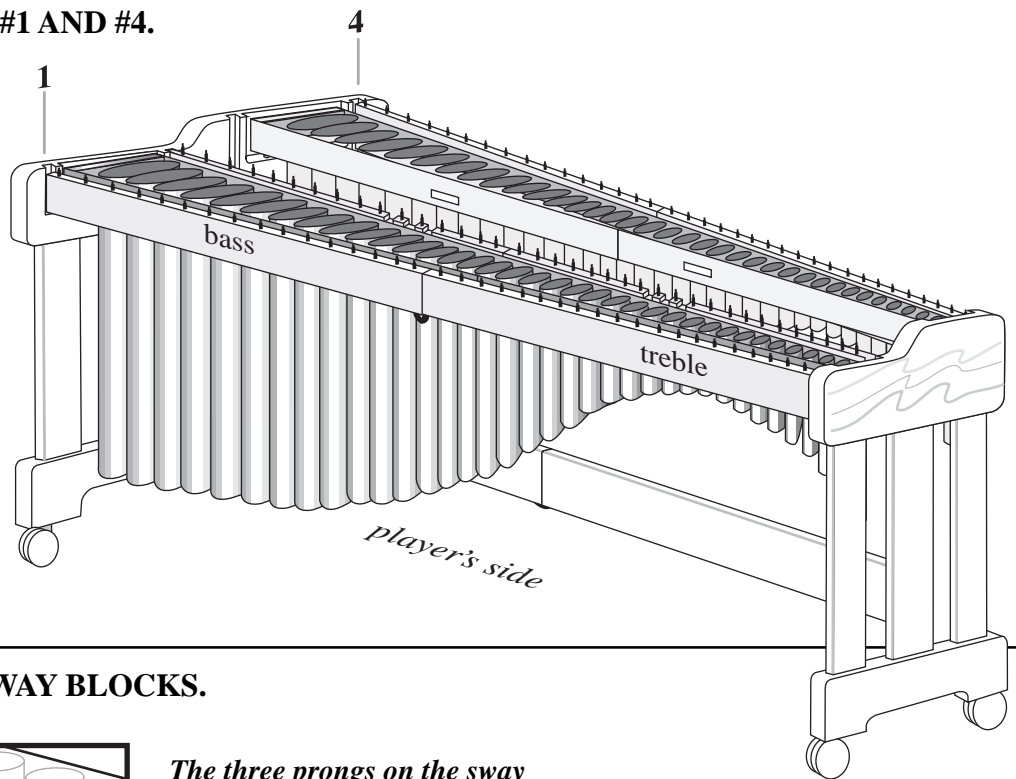

**17**

**INSTALL THE SWAY BLOCKS.**

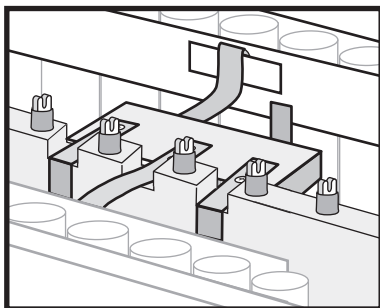

*The three prongs on the sway blocks always point toward the player.*

- Position the sway block over the notches in Rail #2.
- Hook the long tabs onto the resonator banks.

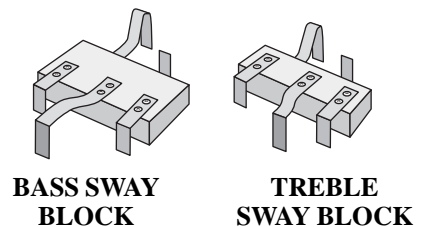

# 18

## INSTALL RAIL #3.

The rail will be placed over the sway block tabs, and onto the pins like the other rails.

*Make sure it is fully engaged onto the pins in the end frame.*

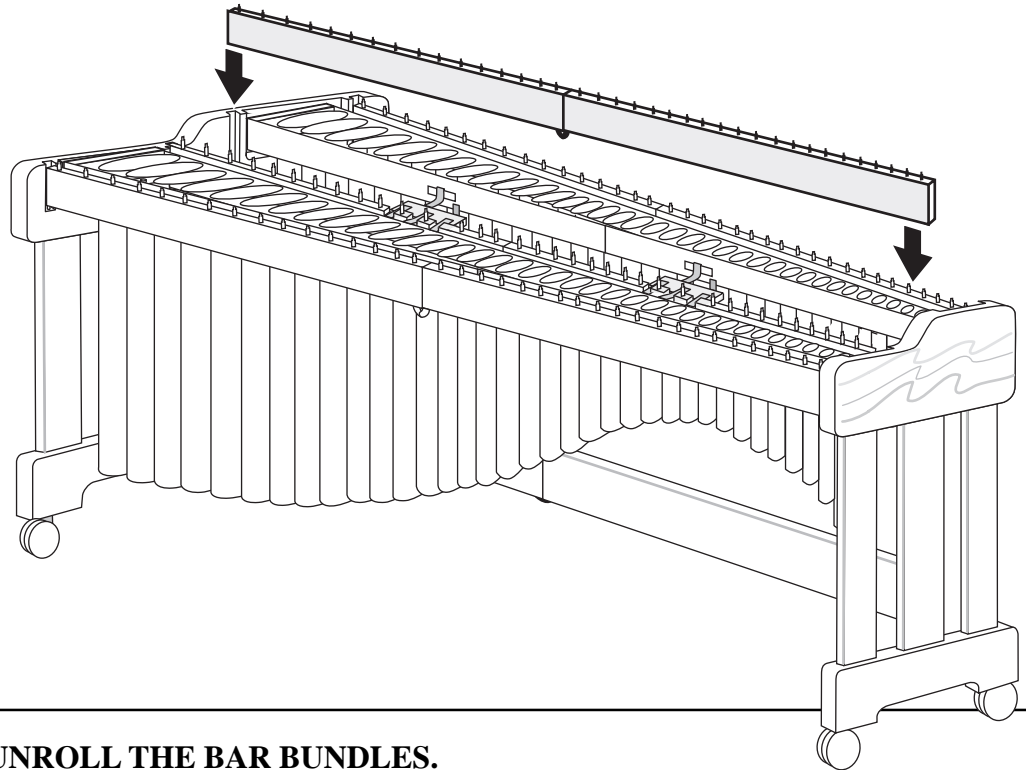

# 19

## CAREFULLY UNROLL THE BAR BUNDLES.

*The larger bar bundle holds the natural bars and goes over the natural resonators. The smaller bundle holds the accidental bars and sits over the accidental resonators.*

**With your assistant at one end and you at the other, lift the natural bars and lay them over rail #1 and #2.**

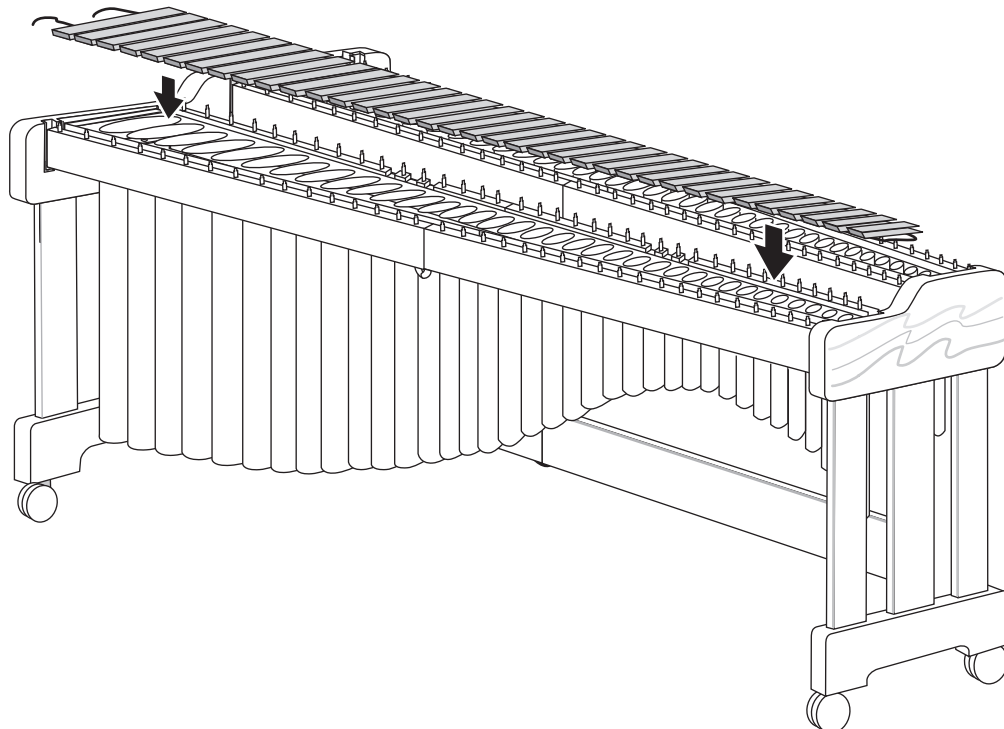

**20****POSITION THE BARS ON THE RAILS.**

- Move each bar into its correct position, making sure that the cord rests in the rail jack slots between each bar.
- Wrap the bar cord around the corner jacks at the treble end.

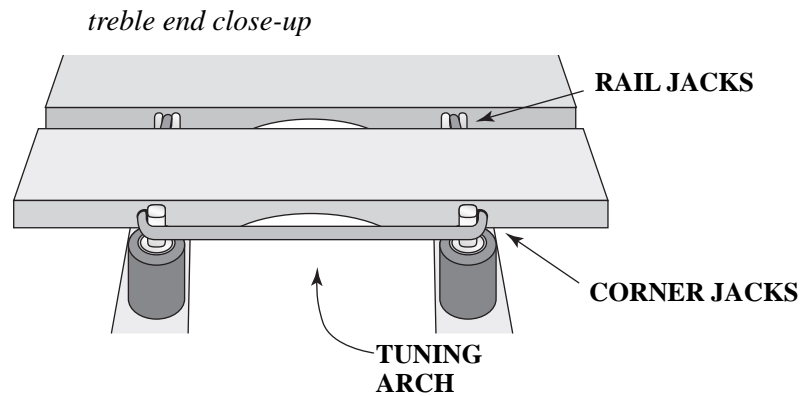
**21****SECURE THE BARS TO THE RAILS.**

Once all the bars are in place, from the bass end pull the cord taught (pulling evenly on each end of the cord at the same time), hook the springs together, and loop the cord around the corner jacks.

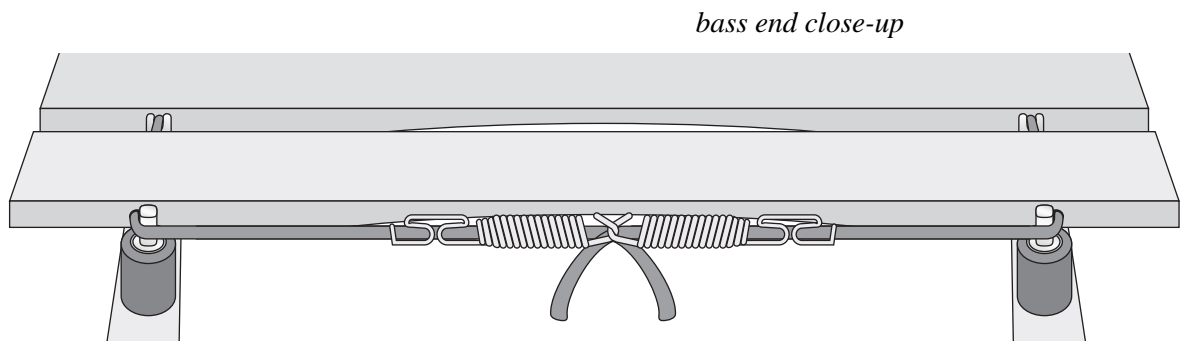
**22****FOLLOW THE SAME PROCEDURE FOR THE ACCIDENTAL BARS.**

The bars go over every resonator that is plugged.

*When you look from the top, you should see the floor through the resonators that are without bars over them.*

## ADJUST THE DISTANCE BETWEEN THE RESONATORS AND BARS ON THE BASS END.

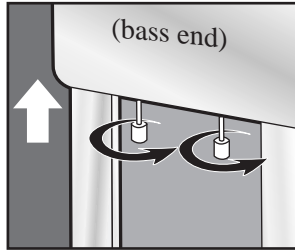

Turn the tuning knobs equally in the same direction until they elevate the bass most resonator to approximately one inch below the arch in the lowest bass bar.

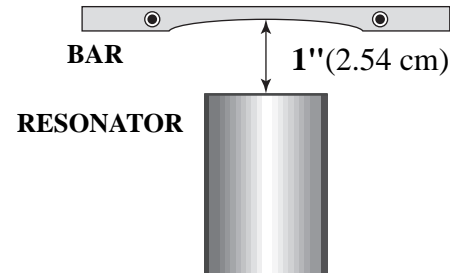

- This would be typical for a 70°F (21°C) playing temperature.
  - For warmer temperatures, move the resonators closer to the bars and for cooler temperatures move the resonators farther away from the bars.
- It is very important to experiment with different resonator height. You will soon be accustomed to listening for the optimal resonator/bar relationship.*

## bar cord tension

*Over time, as you play your instrument, the cord that suspends the bars may loosen and need to be adjusted. To increase tension in the bar cord, use the cleats behind the springs to hold the slack in the cord.*

### 1. UNHOOK THE SPRINGS.

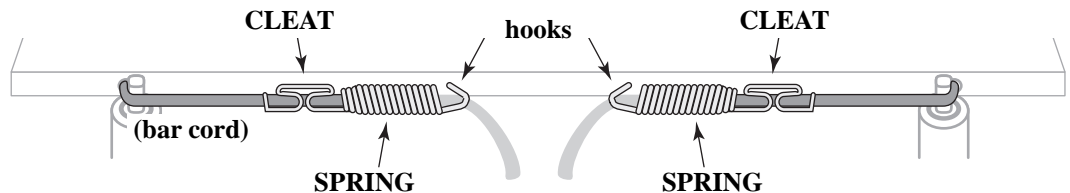

### 2. AT THE CLEAT, PULL THE CORD TO MAKE ENOUGH SLACK TO FORM A LOOP.

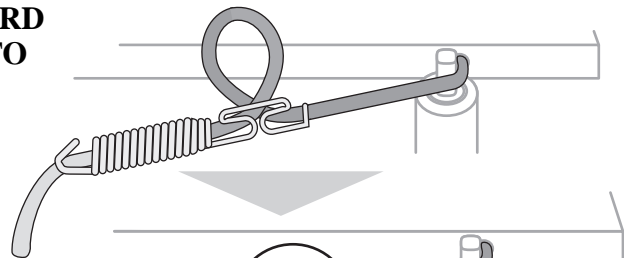

### 3. • Slip the loop down around the cleat. • Pull the cord taunt.

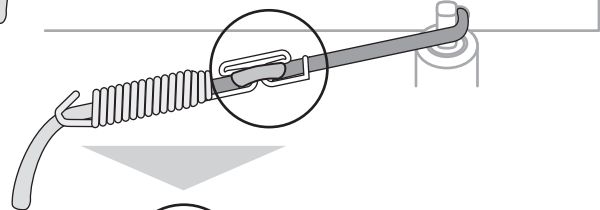

### 4. RE-HOOK THE SPRINGS.

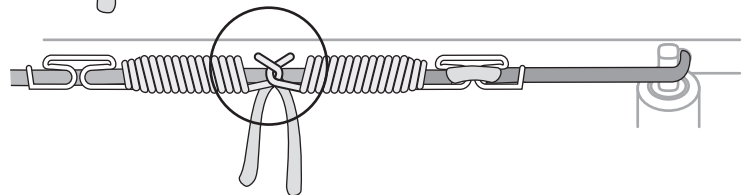

*NOTE: In time, the cord may become loose again. Do not exceed a maximum of THREE loops around each cleat.*

## marimba cleaning

**USE A SOFT COTTON RAG OR TOWEL  
DAMPENED WITH WATER ONLY.**

***DO NOT USE FURNITURE POLISH on your marimba!***  
*Many of these products contain silicone, which will damage  
the finish and contaminate the wood.*

## moving the marimba

**THE MARIMBA SHOULD ONLY BE LIFTED BY THE END FRAMES.**

- Lifting by the rails will cause the rails to come out of their slots.
- When the marimba is moved, pass very slowly over doorjambs, electrical cords, or uneven surfaces.



**DURING ASSEMBLY, DO NOT ATTEMPT TO MOVE THE  
FRAMES AND SUPPORT UNTIL ALL FOUR RAILS ARE  
IN PLACE; THE CENTER SUPPORT MAY CRACK!**

*Cracks in the center support resulting in side to side movement before  
the rails are installed will not be covered by your frame warranty!*

## sagging bars

*With time, the natural or accidental bars  
may sag over the length of the marimba.*

### **CAREFULLY REMOVE THE BARS.**

- Lift out the rail that is no longer level and fold the rail to expose the stainless steel leveling screws.
- Loosen ONE of the screws about an eighth of a turn from its present location.

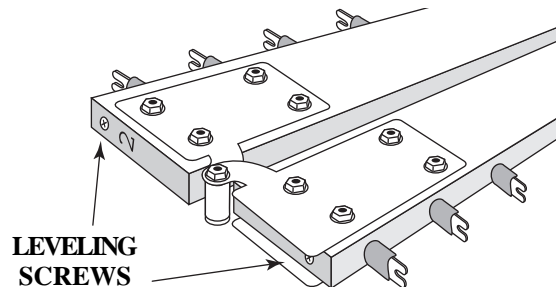

*Replace the rail and check it again. Reposition the bars as before.*

# keyboard diagram

In all correspondence, please refer to your marimba bars according to the diagram. This will make communication much easier, regarding the tuning or replacement of your bars.

*Thank You!*

**MAILING:**

**marimba one**® Inc.  
P.O. Box 786  
Arcata, CA 95518 - U.S.A.

**SHIPPING:**

**marimba one**® Inc.  
901 O Street  
Arcata, CA 95521 - U.S.A.

Telephone: (707) 822-9570  
Toll-free: (888) 990-6663 (U.S.A.)

Fax: (707) 822-6256

Email:  
[percussion@marimba1.com](mailto:percussion@marimba1.com)

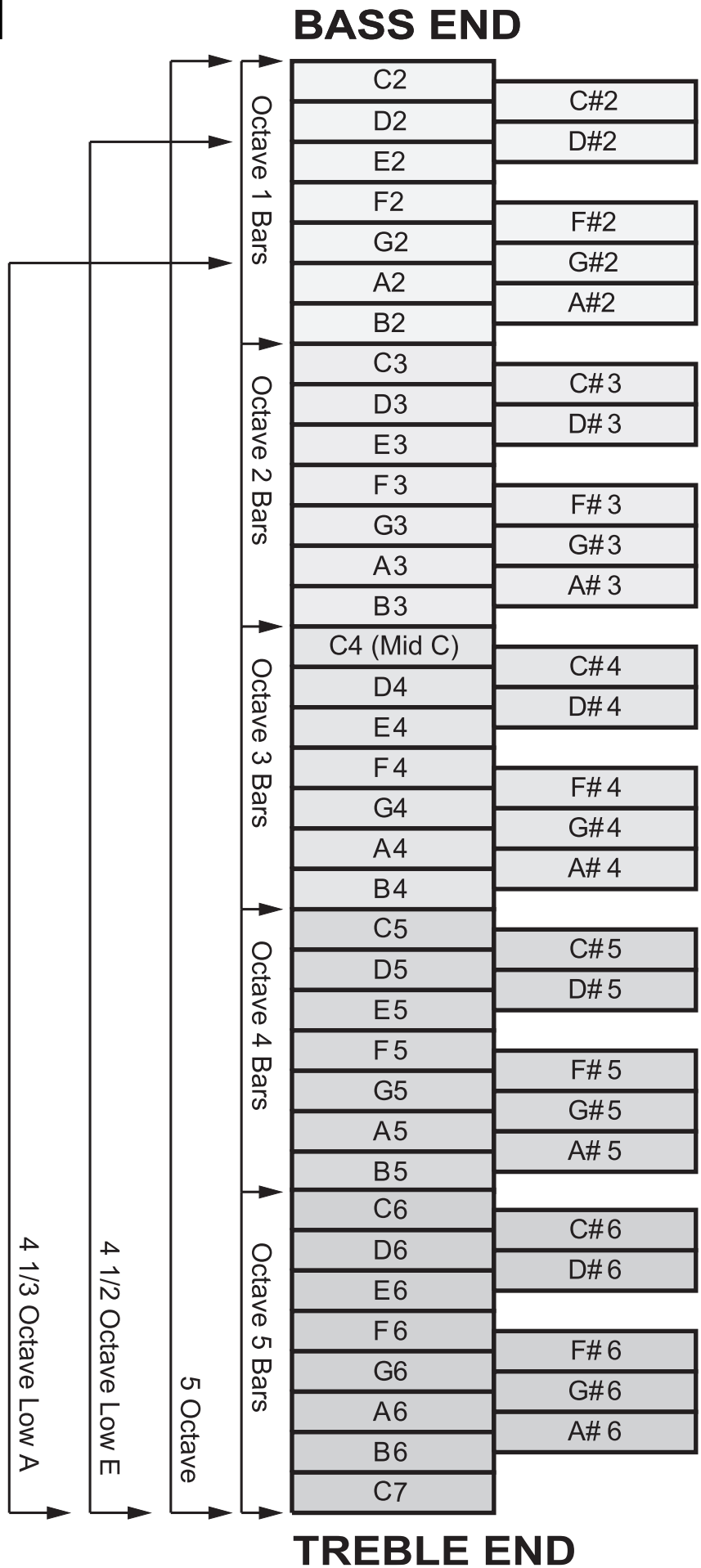

**BASS END**

**TREBLE END**